

I° VARIANTE APPROVATA - CALCOLO VOLUMETRIA LOTTI B1c PER TIPO EDILIZIO
SCALA 1:200

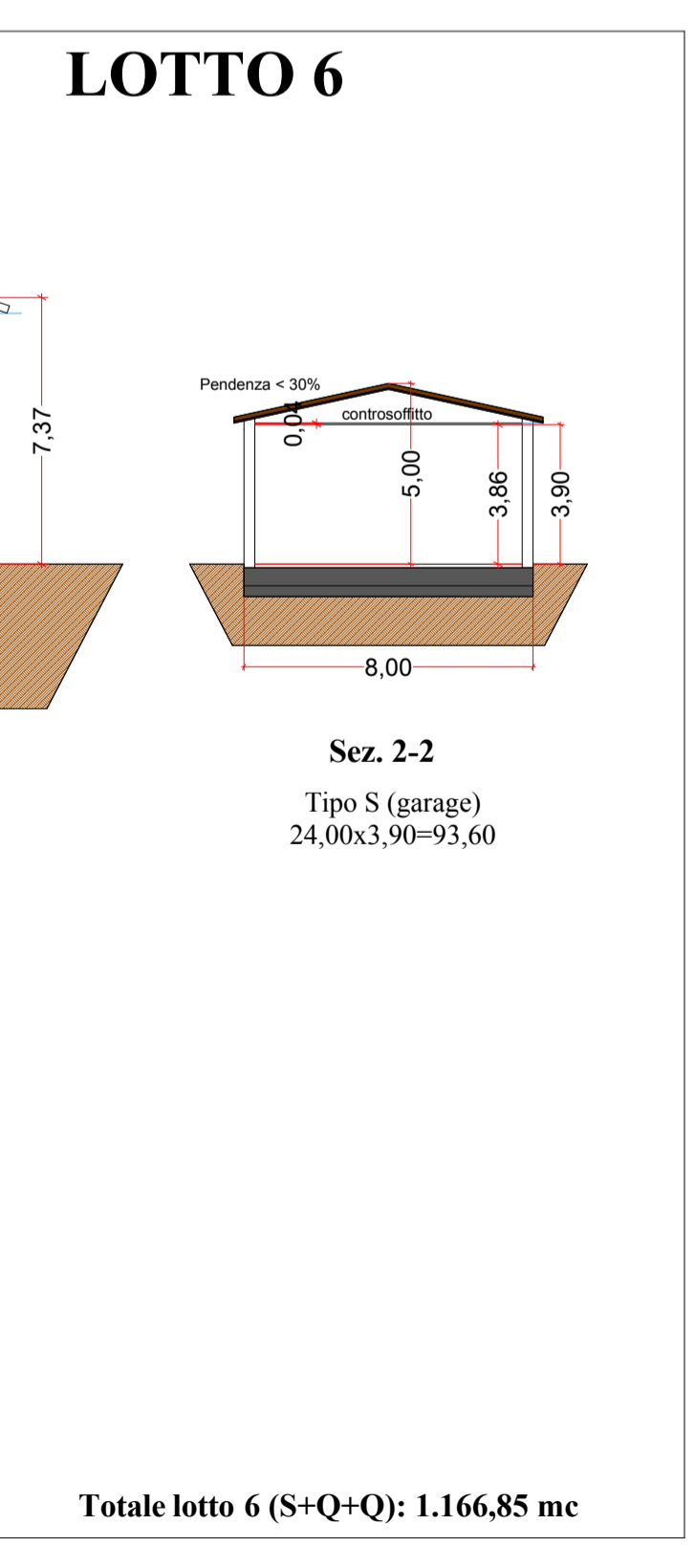

II° VARIANTE - CALCOLO VOLUMETRIA LOTTI C2b PER TIPO EDILIZIO
SCALA 1:200

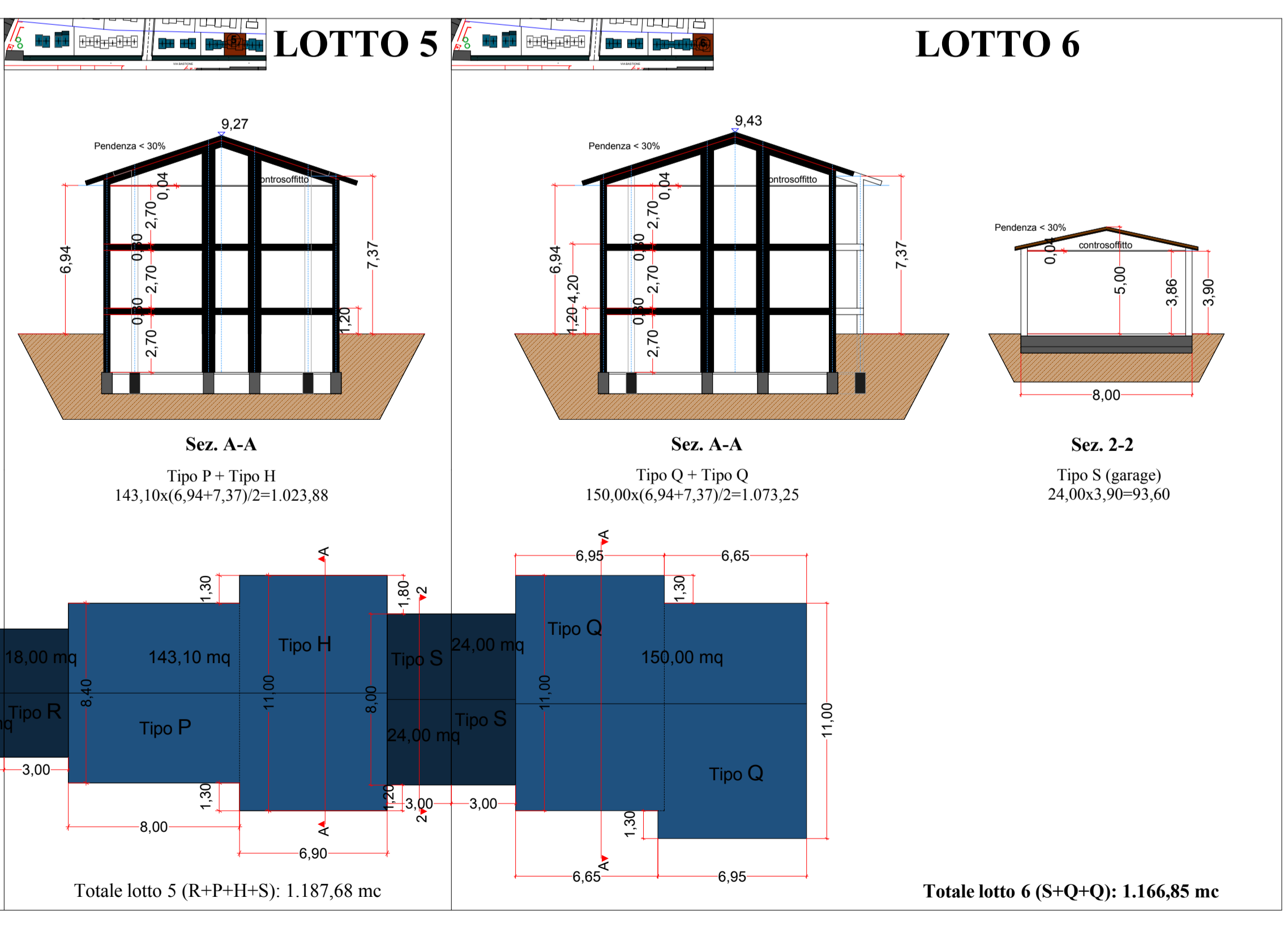
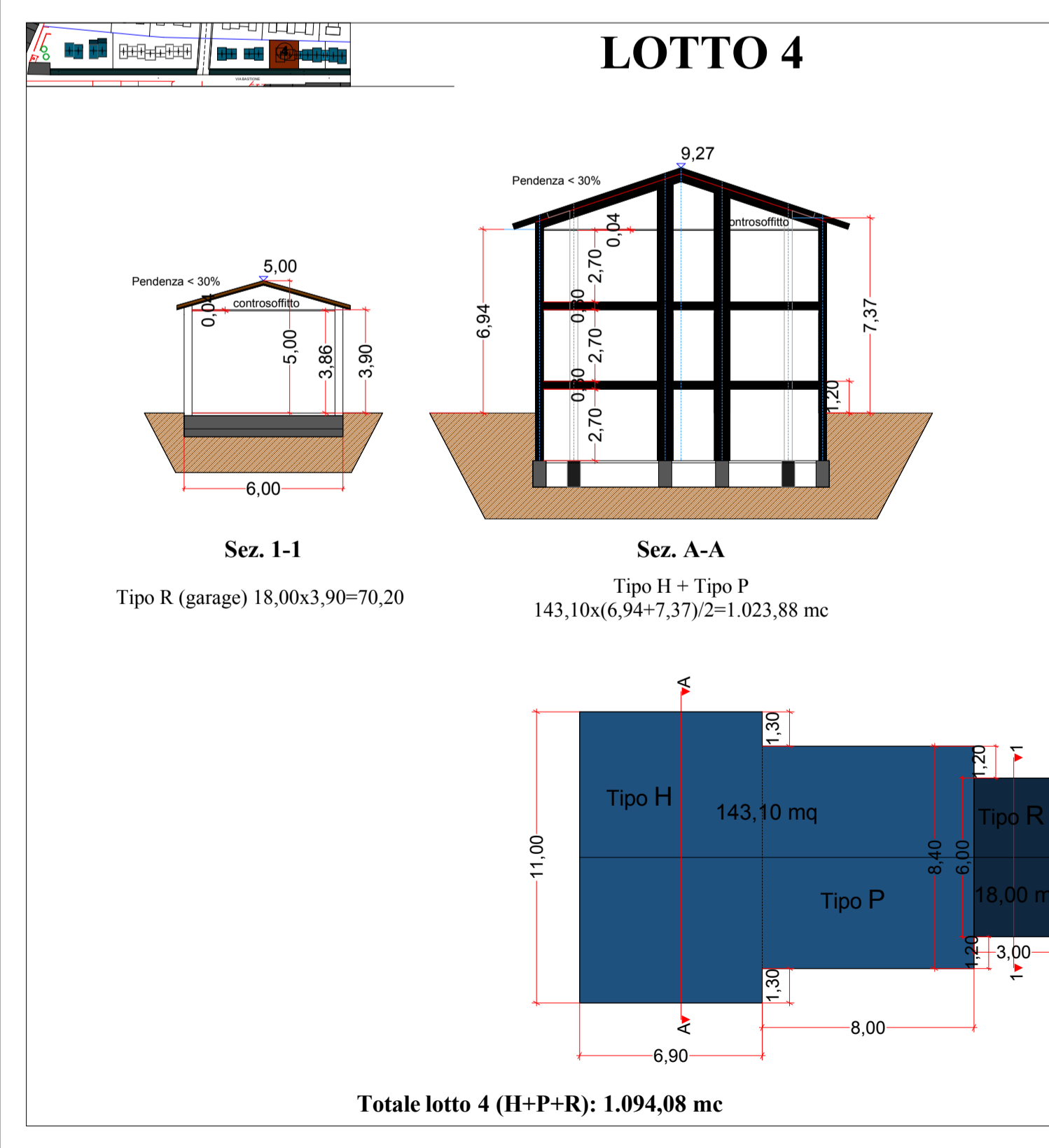
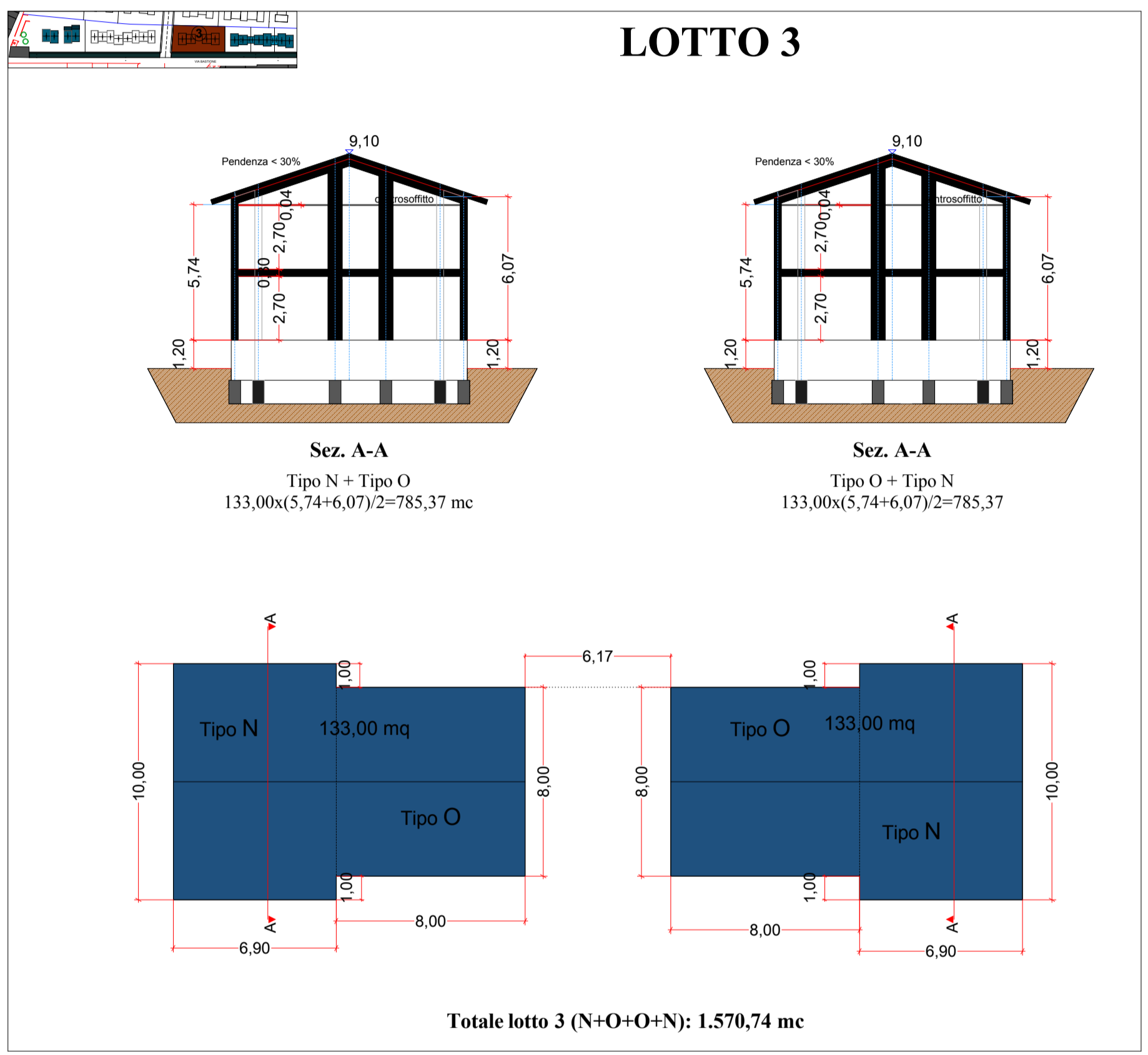
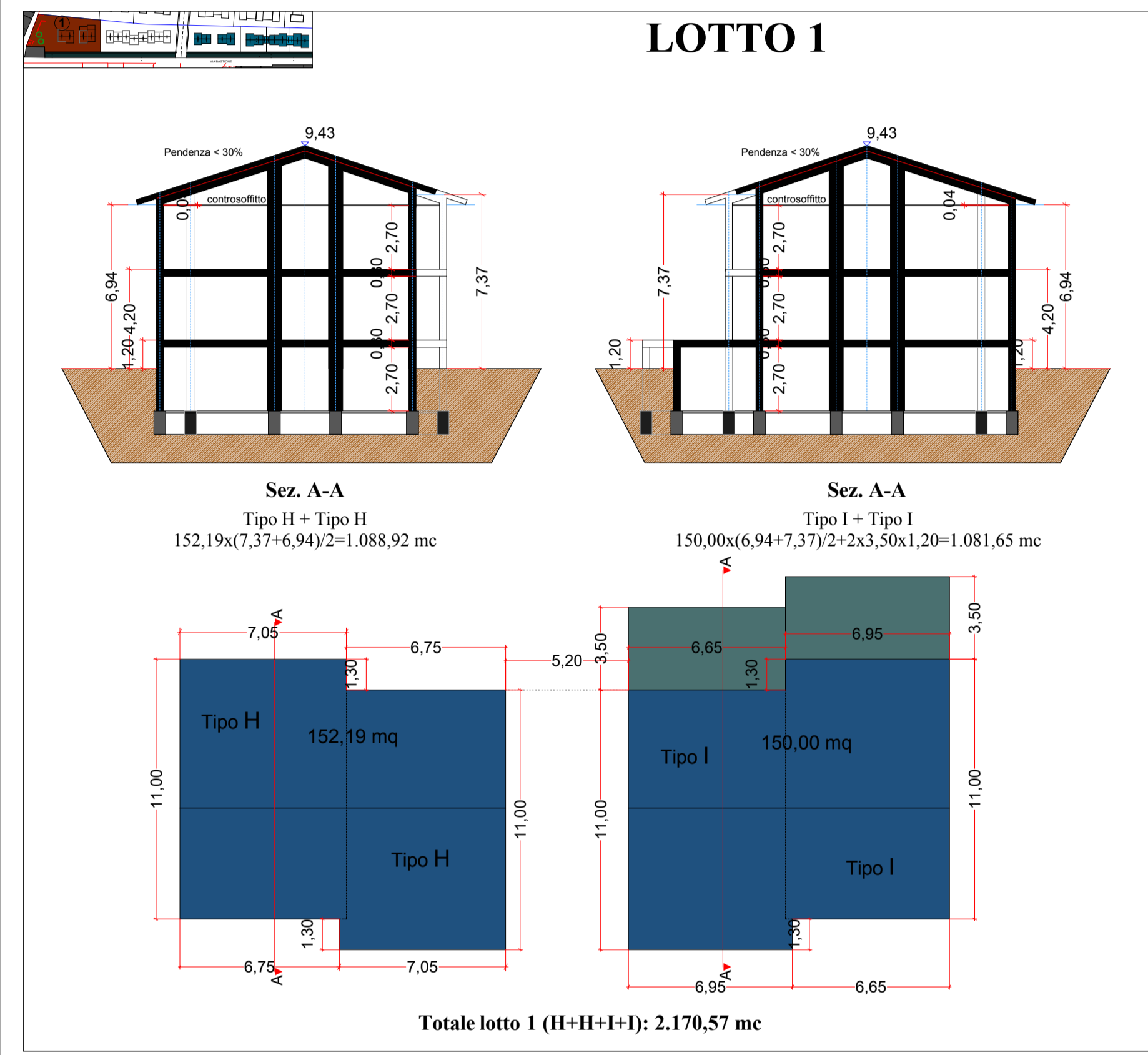
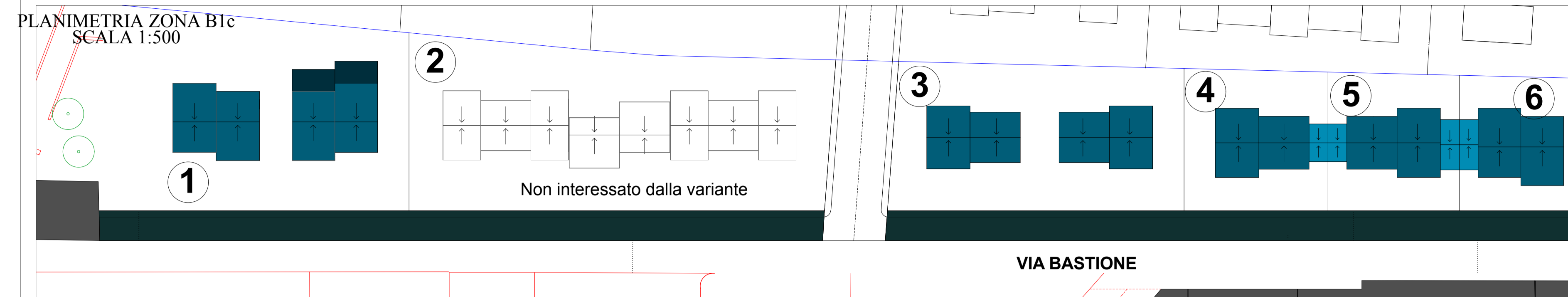
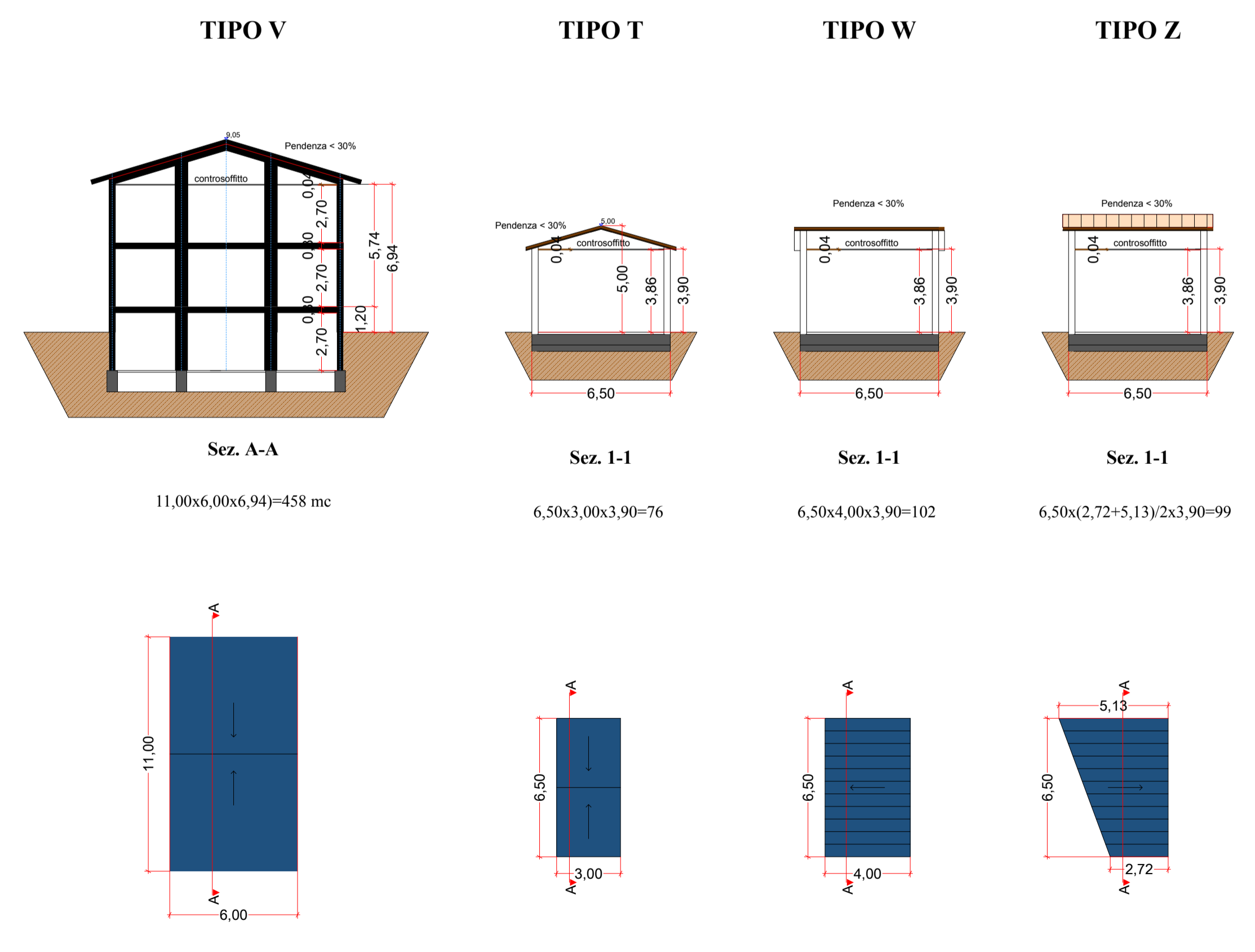
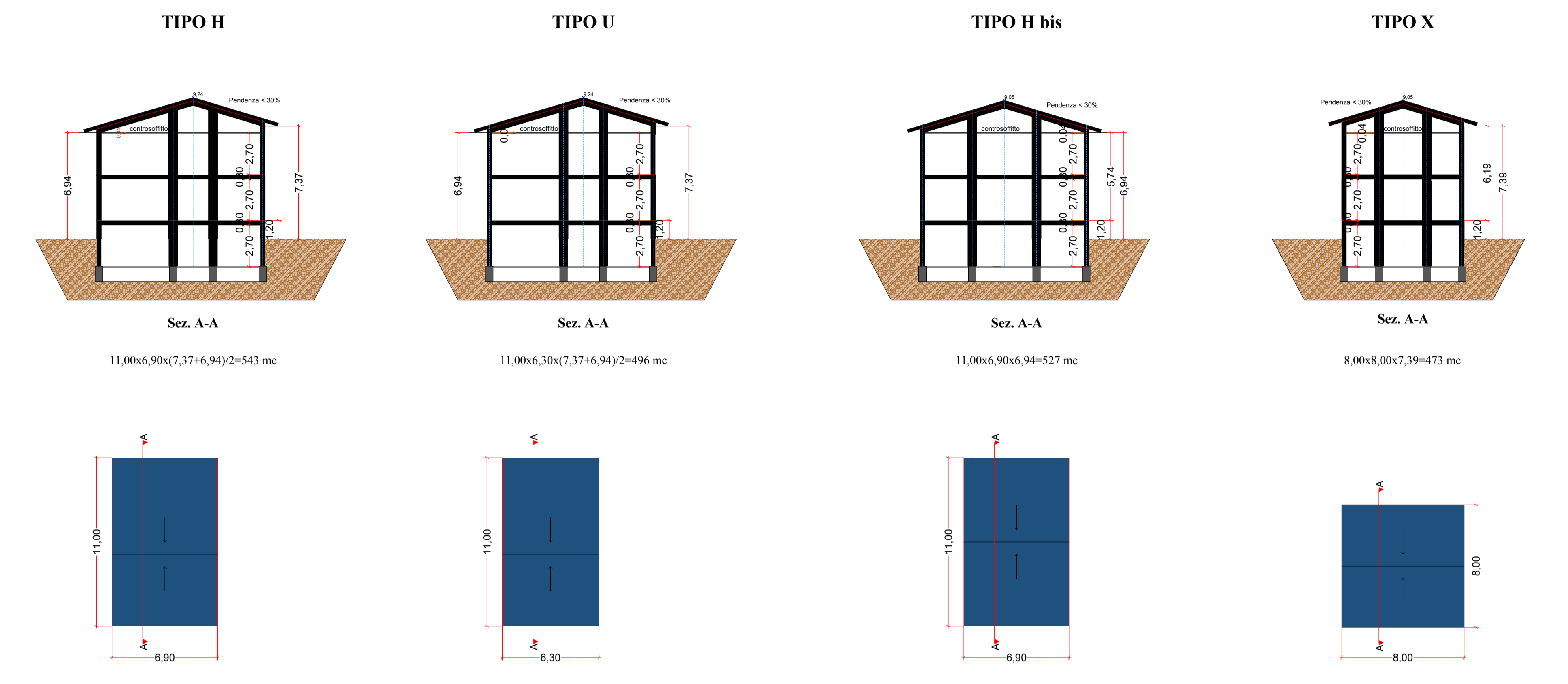

COMPARTO C2b

TABELLA LOTTI					
LOTTO	TIPOLOGIA FABBRICATI	CUBATURA (mc)	LOTTO	TIPOLOGIA FABBRICATI	CUBATURA (mc)
A1	X - Z	572	D2	H bis - T	603
A2	V - T	534	D3	H bis - T	603
A3	V - T	534	D4	H bis - T	603
A4	X - W	575	D5	H bis - T	603
B1	U - T	572	D6	H bis	527
B2	U - T	572	E1	H - T	620
B3	U - T	572	E2	H - T	620
B4	U - T	572	E3	H - T	620
B5	H - T	620	E4	H - T	620
B6	H - T	620	E5	H - T	620
B7	H - T	620	E6	H - T	620
B8	H - T	620	E7	H - T	620
B9	H - T	620	F1	H - T	620
C1	H - T	620	F2	H - T	620
C2	H - T	620	F3	H - T	620
C3	H - T	620	F4	H - T	620
C4	H - T	620	F5	H - T	620
C5	H - T	620	F6	H - T	620
C6	H - T	620	F7	H - T	620
C7	H - T	620	F8	H - T	620
C8	H	543	F9	H - T	620
D1	H bis	527	F10	H	543

COMUNE DI MILAZZO

DITTA: "AZIENDA AGRICOLA S. MARINA s.r.l."

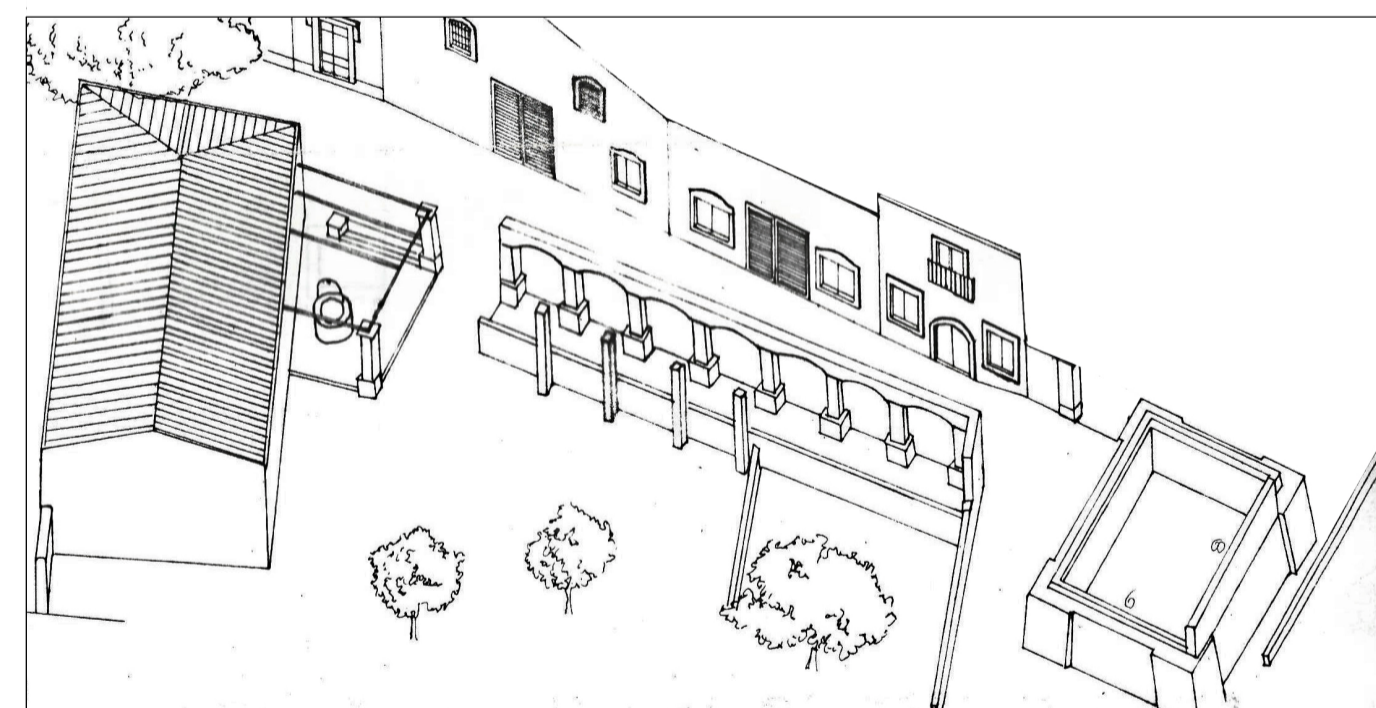

PIANO DI LOTTIZZAZIONE in C.da SANTA MARINA
(Approvazione I delibera C.C. n°63 del 31/05/2007)
(Approvazione I Variante delibera C.S. n°3 del 12/06/2014)

II° VARIANTE

VOLUMETRIA FABBRICATI

PROGETTISTI

arch. PATRIZIA MERLINO

ing. ALBERTO BONACCORSI

TAVOLA

6

Data: